

8

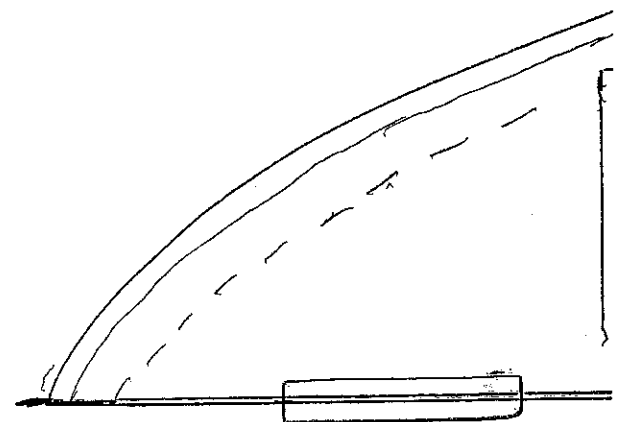

⑤

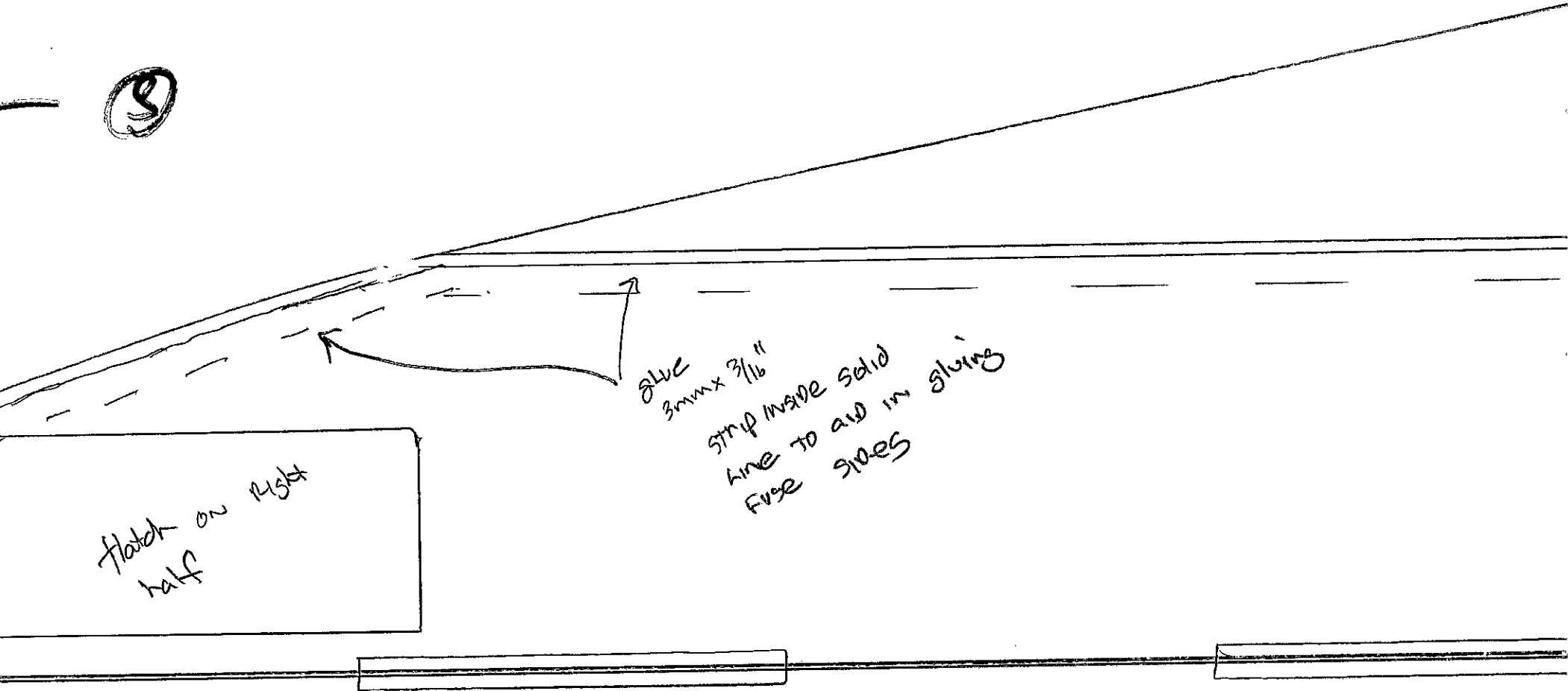

⑥

Top view Fuse 6mm
Flip over and trace
other Half

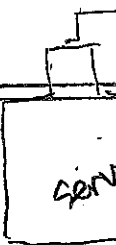

6

11

↙ control
horn

11

control horn



↙ motor mount
glue to top view
FUSE

12

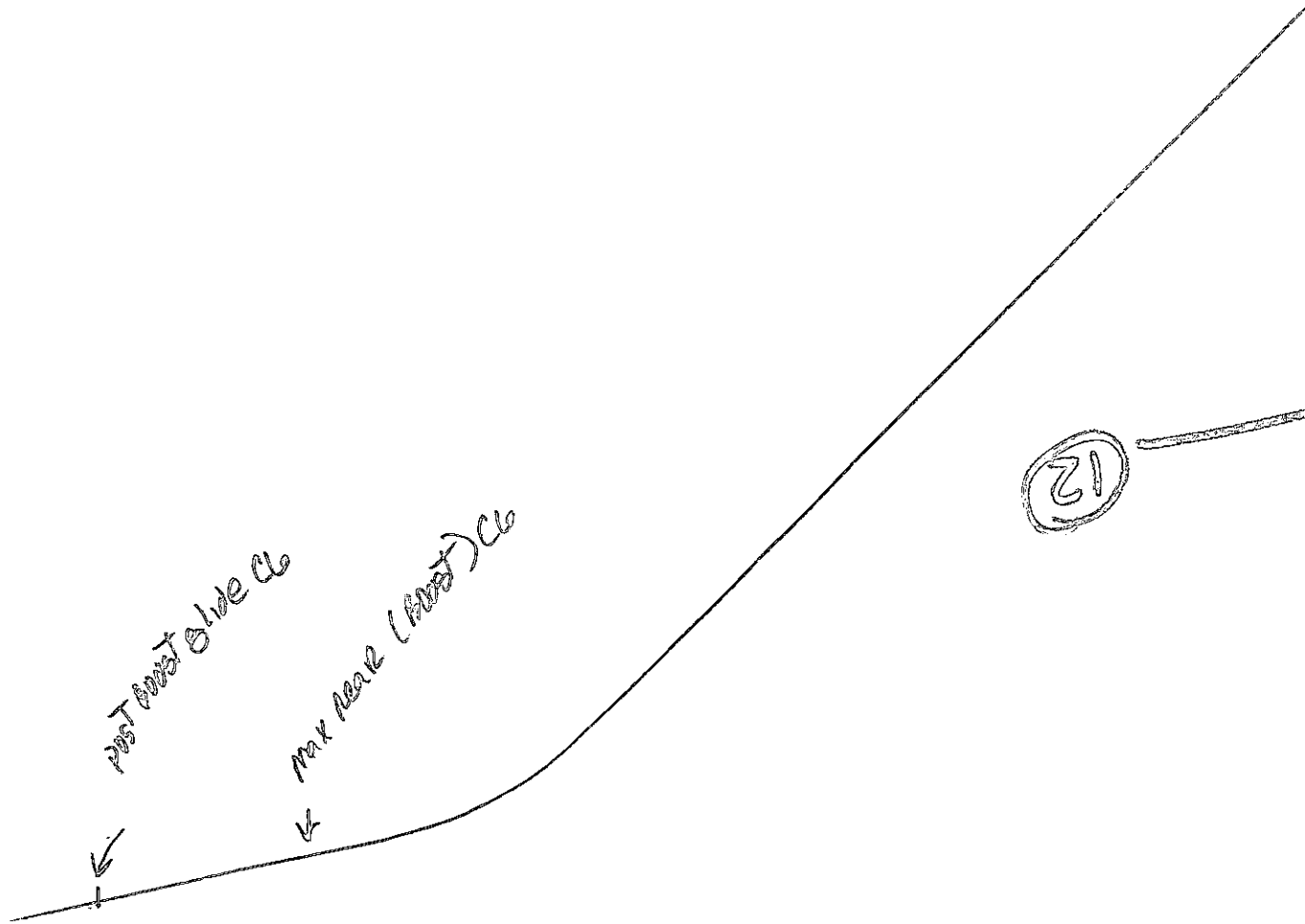

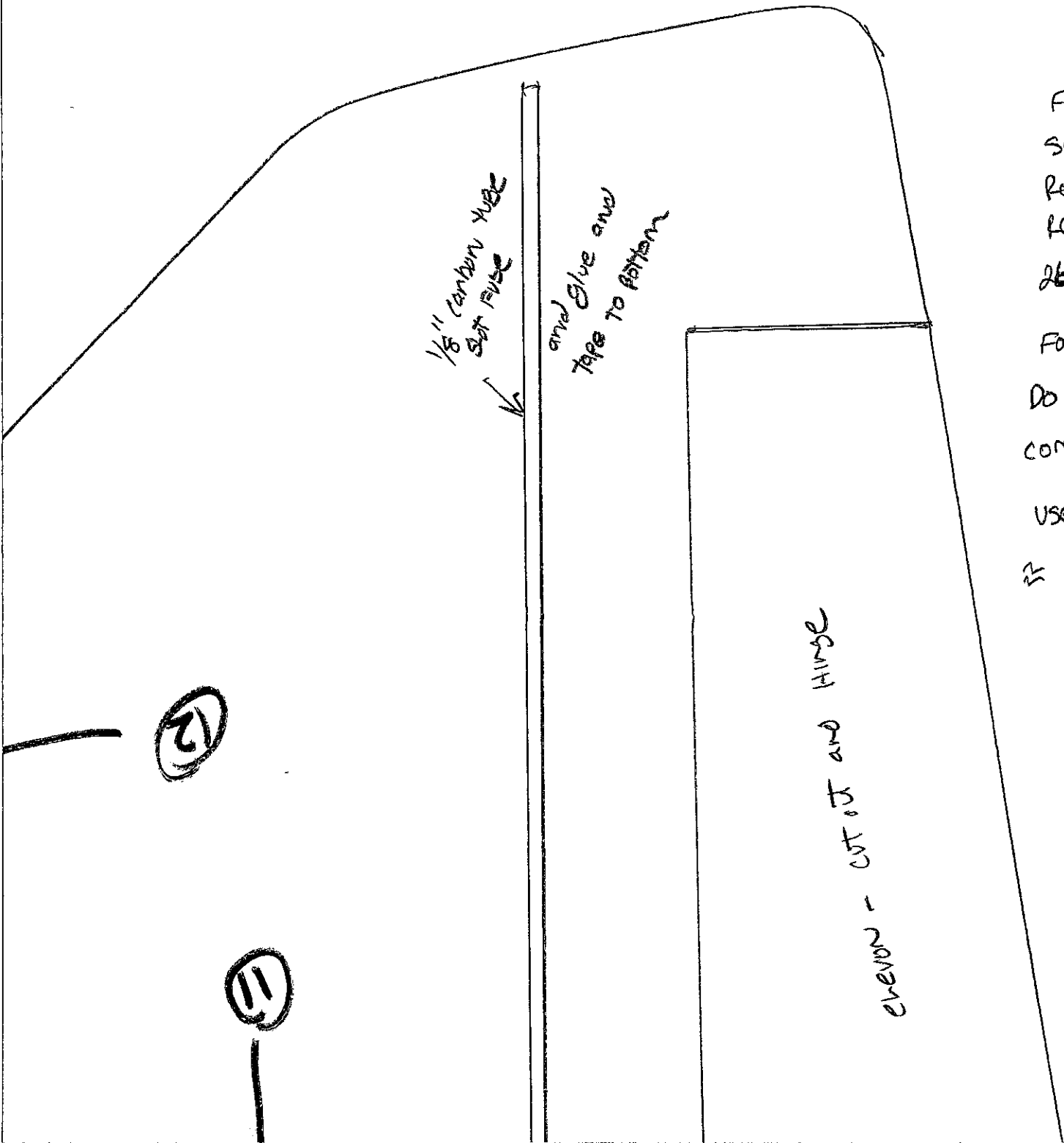

2011
Frank Burke
Space Shuttle
Rocket Boosted
RC Glider
26" w/ 35" length

For personal use only
Do not reproduce for
commercial use!

Use AeroTech E-16 RC payload
E Hot RTF

evening - cut out and hinge

↳ Laminate sheets to make
Block or use solid block
to carve cockpit to shape

↳ glue 3mm x 1/4" strip
3/16" IN FROM
edge ON BOTH
SIDES FOR FRONT NOSE PLATE
SUPPORT

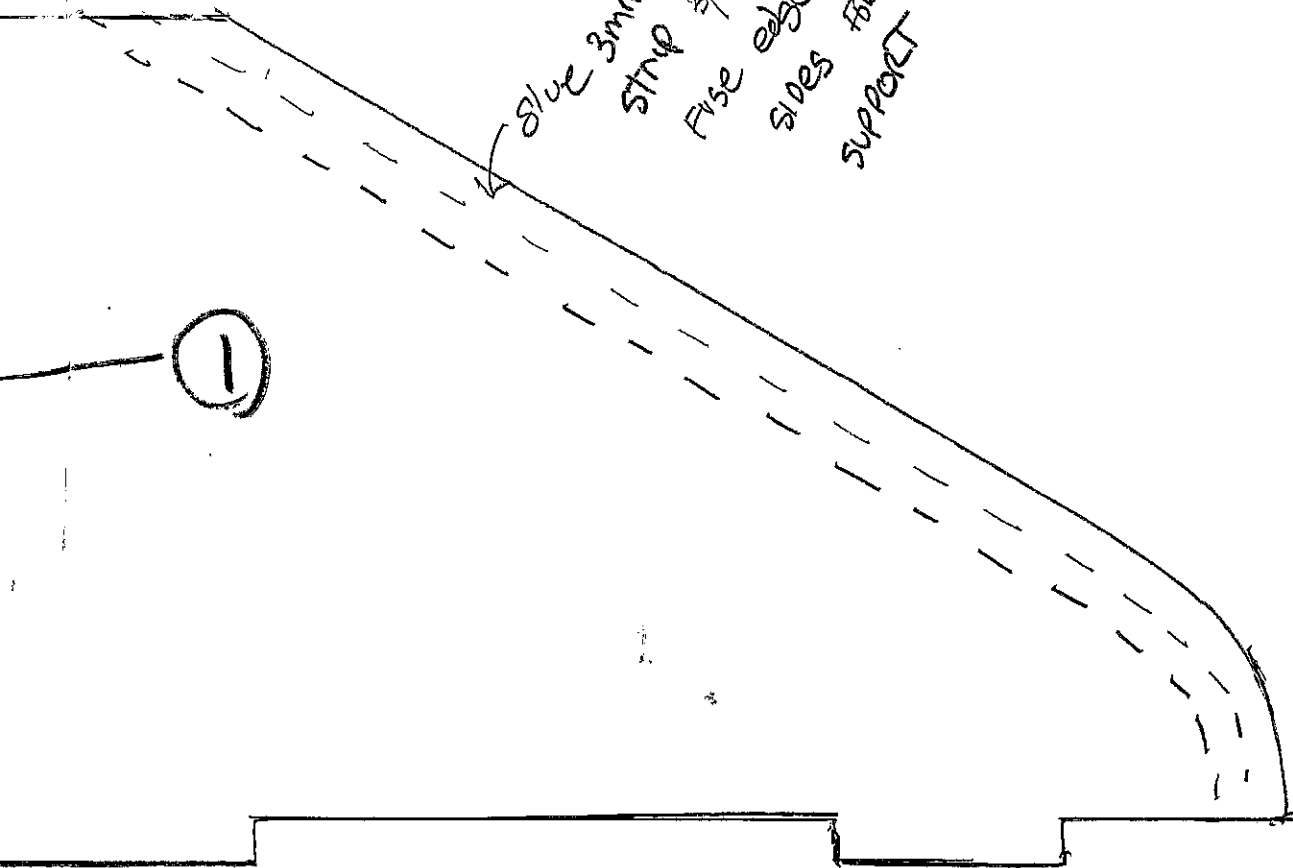

* Rear of model does
NOT HAVE OMS Humps
FOR SIMPLICITY - you
can leave them off and
make a BURAN or
add if you wish -

Middle
BULKHEAD
Location

FRONT BULKHEAD
Location

Slit
1/4" x 6mm
strip to both
sides of FUSE
for gluing FUSE top

2

1

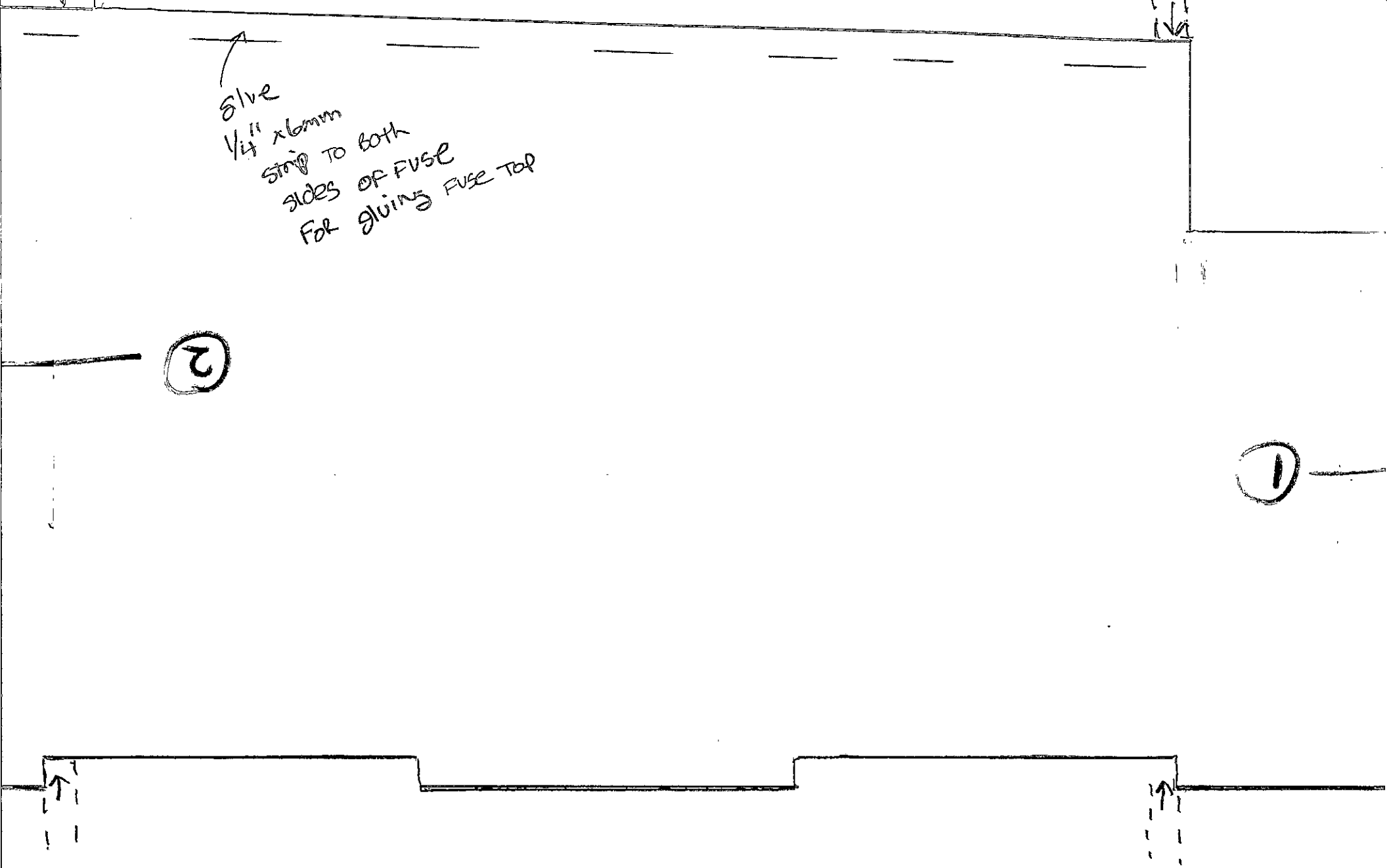

Rear satellite Bay BULKHEAD

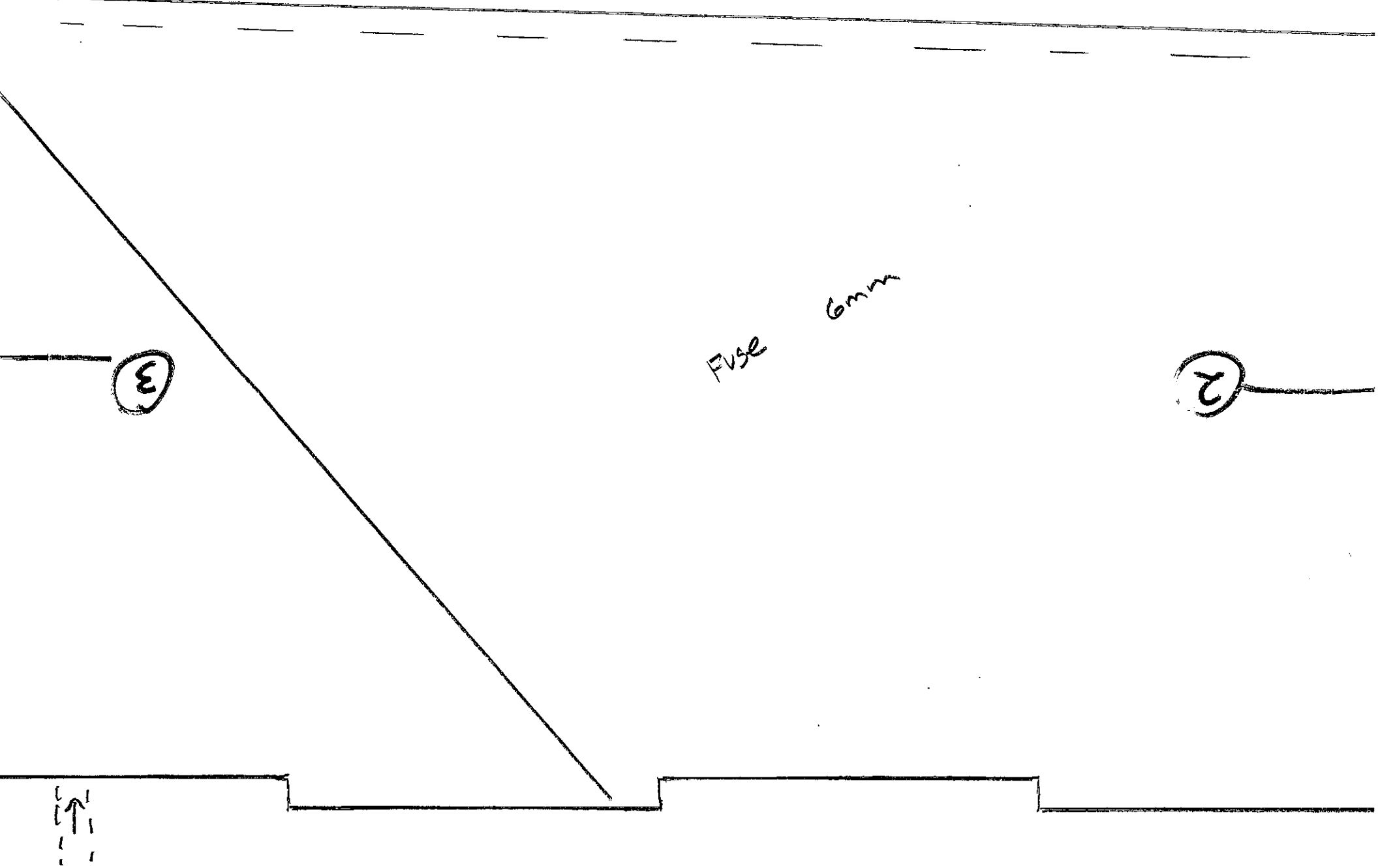

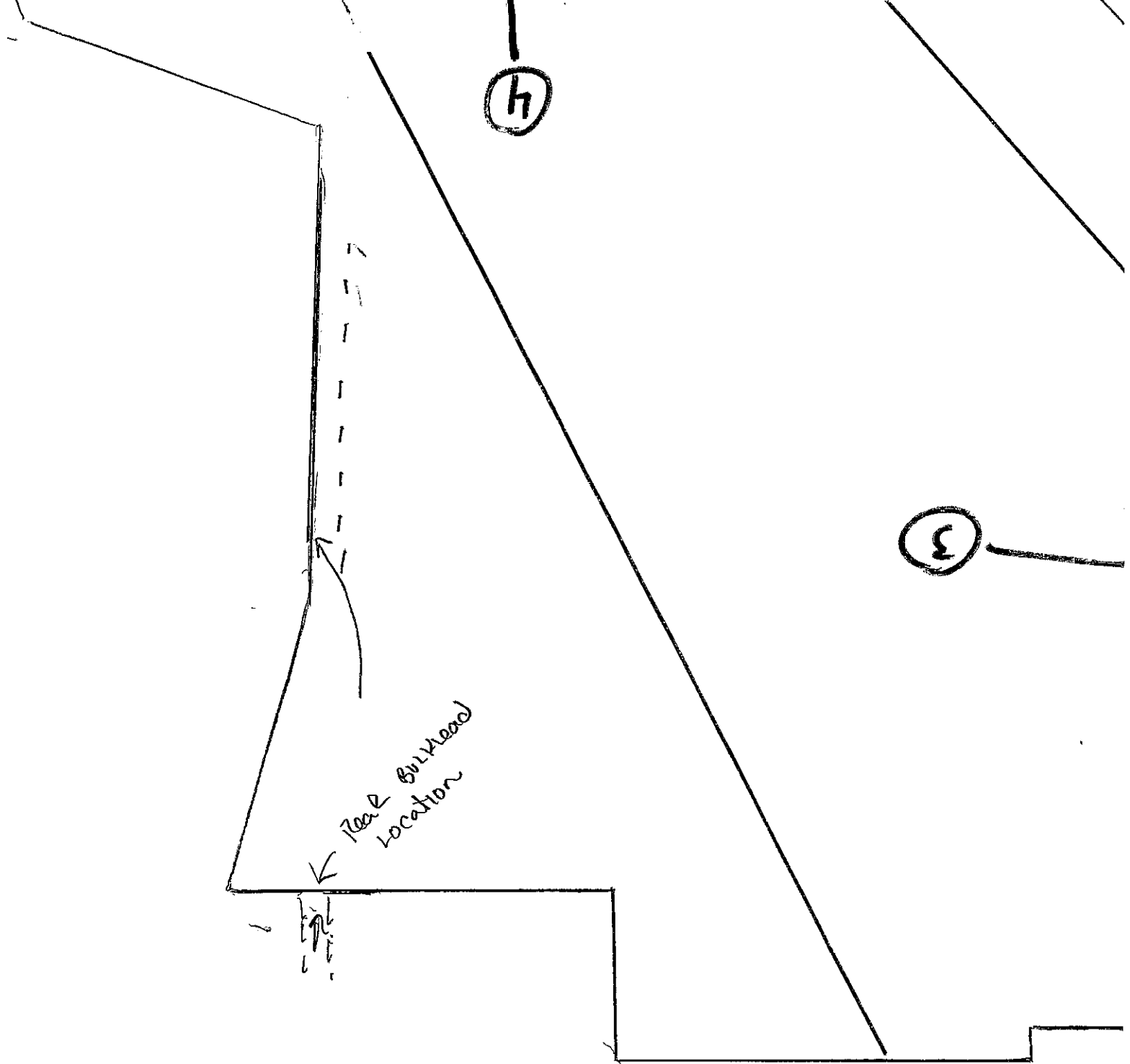

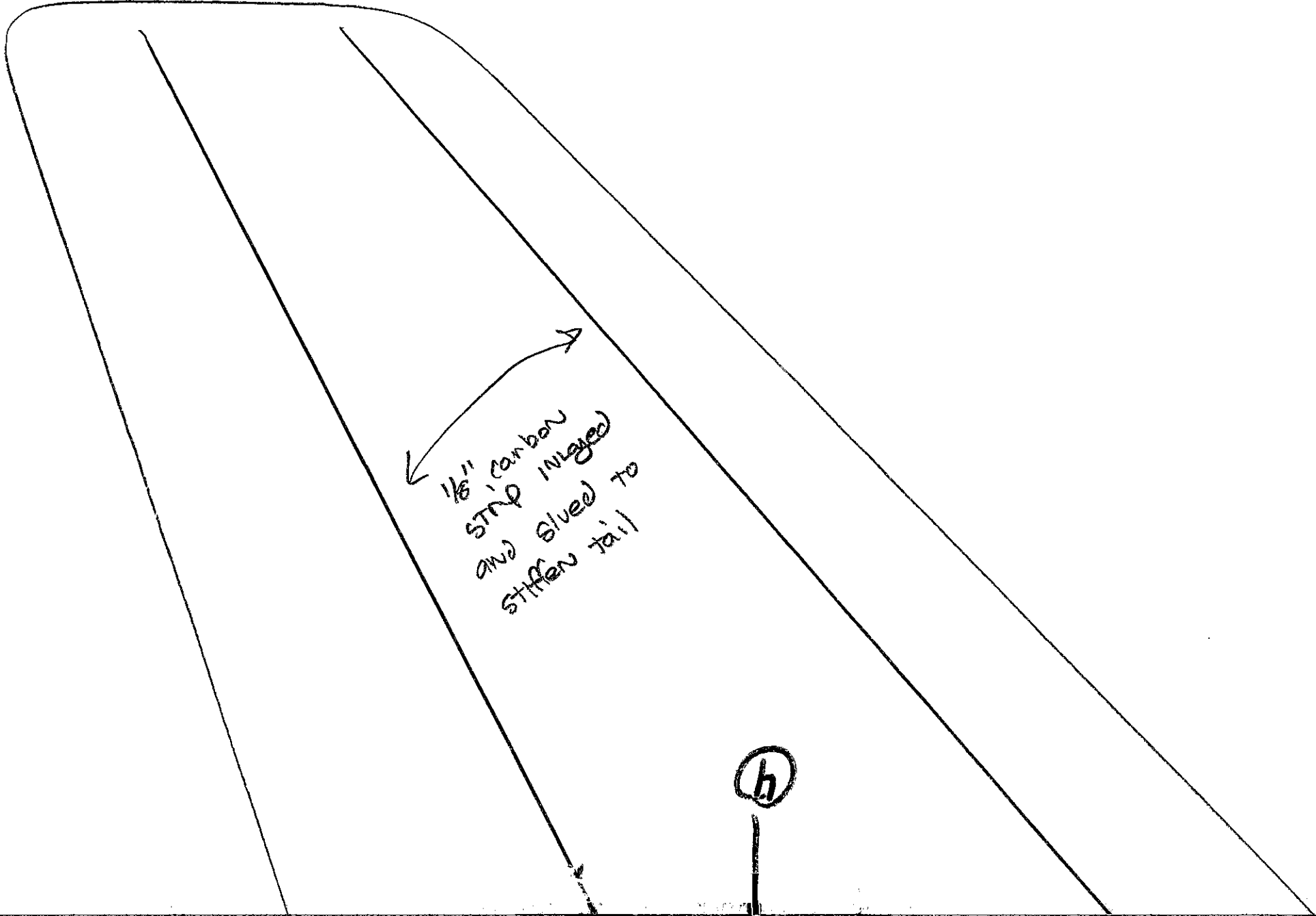

← 1/8" carbon
strip inserted
and glued to
stiffen tail →

h

②

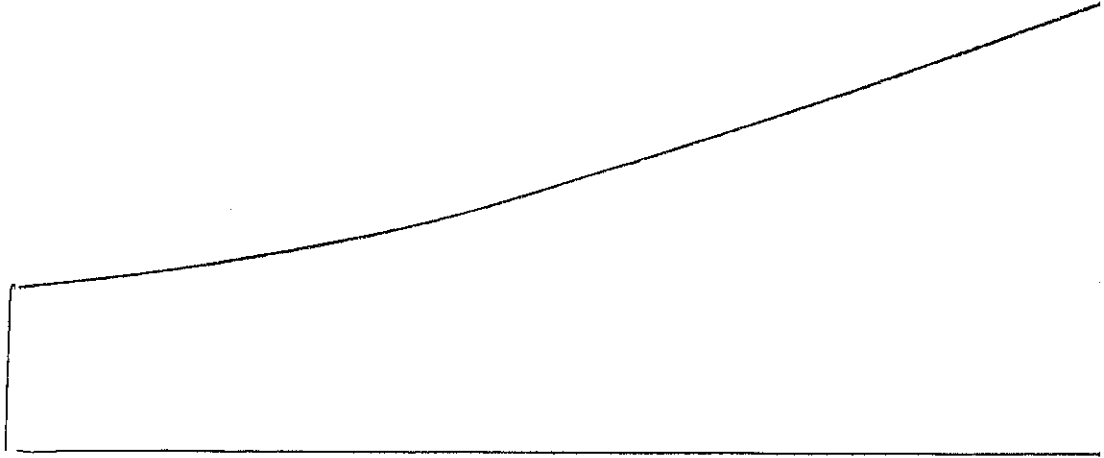



3mm Fuse
sides, make right
and left sides



9

5



↑ TRIM TO
FIT FIN

⑨

